

Rt. Gilmore

No. 3347

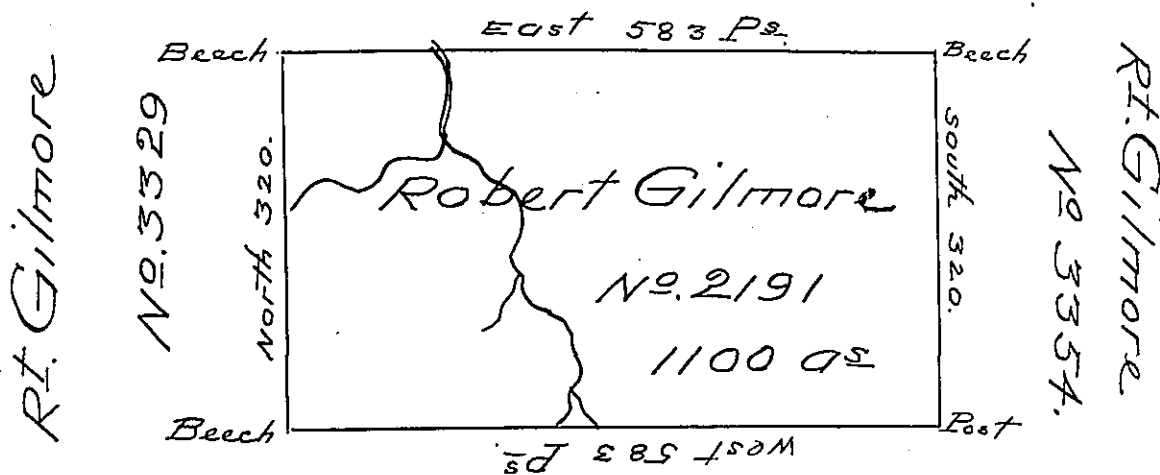

No. 2282

Wm. Bingham Esqr

Situate on the Head of the East Branch
of Ischunungwandt Creek Seven miles South
of the State Line in the Last Purchase District
No. 4 Surveyed June the Twenty Eighth 1793
in Pursuance of a Warrant to Robert Gil-
more No. 2191 Dated the ~~fourteenth~~ ^{twelfth} day of
December 1792 for 1000 Acres -

Containing Eleven Hundred acres and the
usual allowance of six P.C. for Roads.

Pl. James Hunter D.S.

To Daniel Brodhead Esqr. S.G.

June 28th

IN TESTIMONY that the above is a copy of the original remaining on file in
the Department of Internal Affairs of Pennsylvania, made
conformably to an Act of Assembly approved the 16th day of
February, 1833, I have hereunto set my Hand and caused
the Seal of said Department to be affixed at Harrisburg,
this Twenty sixth day of October 1904.

Joae R. Brown
Secretary of Internal Affairs.